

**SURFACE SUMMARY  
FIRST - FLOOR**

1.1 TERRACE	10,0 m <sup>2</sup>
1.2 KITCHEN	8,4 m <sup>2</sup>
1.3 LIVING-ROOM	15,5 m <sup>2</sup>
1.4 ANTECHAMBER	4,1 m <sup>2</sup>
1.5 ROOM	11,4 m <sup>2</sup>
1.6 BATHROOM	5,6 m <sup>2</sup>
1.7 ROOM	11,4 m <sup>2</sup>
1.8 BATHROOM	6,3 m <sup>2</sup>
1.9 LIVING-ROOM	15,5 m <sup>2</sup>
1.10 ANTECHAMBER	4,1 m <sup>2</sup>
1.11 TERRACE	10,0 m <sup>2</sup>
1.12 KITCHEN	8,4 m <sup>2</sup>
1.13 CORRIDOR	4,3 m <sup>2</sup>
1.14 STAIRS	10,6 m <sup>2</sup>
1.15 WARDROBE	2,9 m <sup>2</sup>
1.16 BATHROOM	5,1 m <sup>2</sup>
1.17 ROOM	17,7 m <sup>2</sup>
1.18 KITCHEN	9,3 m <sup>2</sup>
1.19 LIVING-ROOM	28,7 m <sup>2</sup>
1.20 TERRACE	20,0 m <sup>2</sup>
1.21 ANTECHAMBER	4,1 m <sup>2</sup>
1.22 WARDROBE	2,9 m <sup>2</sup>
1.23 ROOM	11,7 m <sup>2</sup>
1.24 BATHROOM	3,0 m <sup>2</sup>
1.25 BATHROOM	3,0 m <sup>2</sup>
1.26 WARDROBE	2,9 m <sup>2</sup>
1.27 ROOM	11,7 m <sup>2</sup>
1.28 ANTECHAMBER	4,1 m <sup>2</sup>
1.29 BATHROOM	5,1 m <sup>2</sup>
1.30 ROOM	11,7 m <sup>2</sup>
1.31 WARDROBE	2,9 m <sup>2</sup>
1.32 KITCHEN	9,3 m <sup>2</sup>
1.33 LIVING-ROOM	28,7 m <sup>2</sup>
1.34 TERRACE	20,0 m <sup>2</sup>
ALL	369,5 m <sup>2</sup>



- a plaster - 1cm
- cement mortar - 1cm
- styrofoam - 10cm
- mortar - 2 cm
- brick - 25 cm
- cement - lime plaster - 2 cm
- gypsum finish

- b brick - 25 cm

- c 2x plasterboard - 2,5cm
- steel construction - 5cm
- 2x plasterboard - 2,5cm

Manifold: 1011										
Type: Manifold with flowmeters										
Manifold set: None										
Secondary side temp. (Heating): 42,7 / 32,9 °C										
Manifold cabinet: NONE										
Feed mass flow: 537,9 kg/h										
Min. required differential pressure: 18,47 kPa										
Available differential pressure: 18,70 kPa										
No.	Type	To terminal unit	Room label	L	Effect. area	Pipe spc.	Obtained heating output	m	Δp	Valve preset (S)
				m	m <sup>2</sup>	mm	W	kg/h	kPa	l/min
1	H/C FL.	108-1-1	Bedroom	24,4	5,1	250	253	32,7	18,3	0,3
2	H/C FL.	102-1-1	Living room	26,4	3,0	250	151	23,9	18,4	0,2
3	H/C FL.	102-2-1	Living room	70,6	17,7	300	885	118,5	8,8	1,0
4	H/C FL.	101-5-2	Living room	80,2	12,0	300 / 150	591	101,4	10,2	0,7
5	H/C FL.	101-5-1	Living room	83,4	17,9	300 / 150	882	150,2	1,1	1,6
6	H/C FL.	117-1-1	Living room	57,2	11,7	300 / 150	584	62,6	16,0	2,4
7	H/C FL.	112-2-1	Bathroom	29,0	2,8	200	120	32,6	18,3	0,1
8	H/C FL.	107-1-1	Living room	25,2	2,6	200	131	16,0	18,5	0,2

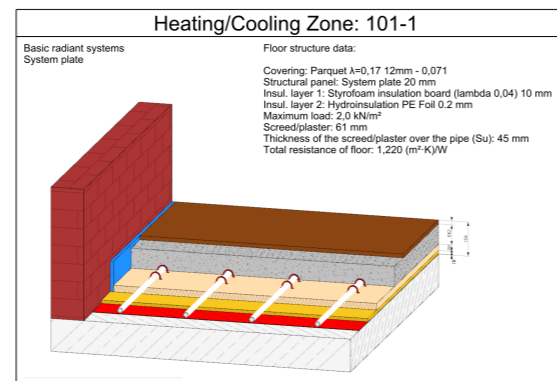

Designer	InstalSoft s.c.	
Project subject	InstalSoft s.c.	
Address	Date	
Investor	Scale	
Designed by	Signature	Drawing no.
Drawn by	Signature	
Verified by	Signature	